

FREEHOLD



House - Mid Terrace (EPC Rating: D)

# 116 SHERDALE AVENUE, CHAPELHALL, AIRDRIE, ML6 8UD

Offers over

# £115,000

## FEATURES

- Mid-terrace family home
- Large lounge with bay window
- Mono bloc driveway
- Views of wooded area
- 2 double bedrooms
- Kitchen opens to rear garden
- Enclosed garden with decking
- Close to schools and shops



**SWEET HOME**



# 2 Bedroom House - Mid Terrace located in Airdrie

Caroline Morrison of Sweet Home Scotland, Welcomes you to this charming two-bedroom mid-terraced family home located on Sherdale Avenue in the desirable area of Chapelhall, Airdrie. Built in 1950, this property offers a delightful blend of character and modern living, spanning an impressive 764 square feet.

As you enter, you are greeted by a hall that leads to a large lounge, featuring a lovely bay window that fills the room with natural light. This inviting space is perfect for relaxing or entertaining guests. The kitchen, conveniently located off the lounge, provides access to the rear garden, making it easy to enjoy outdoor dining or simply bask in the fresh air.

The upper level of the home comprises two generously sized double bedrooms, ideal for a family or those seeking extra space. The family bathroom is also situated on this floor, ensuring convenience for all.

Externally, the property boasts a mono bloc driveway, providing off-street parking, while the enclosed rear garden features a well-maintained lawn and a decking area, perfect for summer gatherings. The garden also offers picturesque views of the surrounding wooded area, creating a tranquil retreat right at your doorstep.

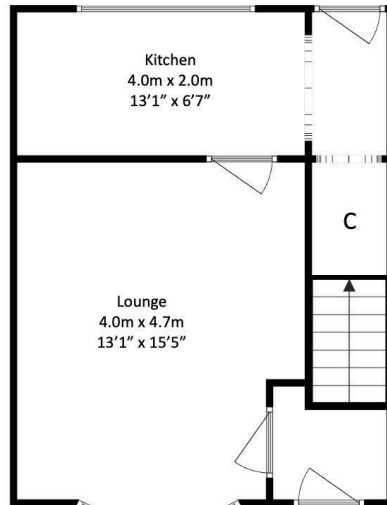

Ground Floor

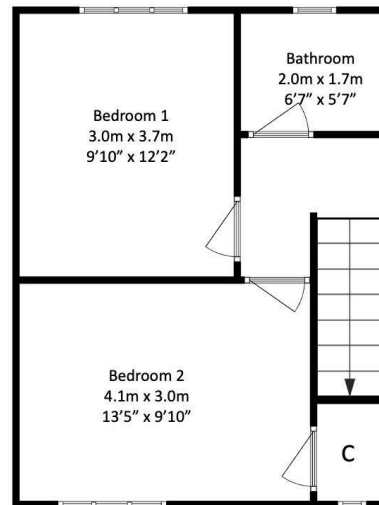

First Floor

Call us on

01236 677500

[sales@sweet-home.co.uk](mailto:sales@sweet-home.co.uk)

<https://sweet-home.co.uk/>

Council Tax Band

**A**

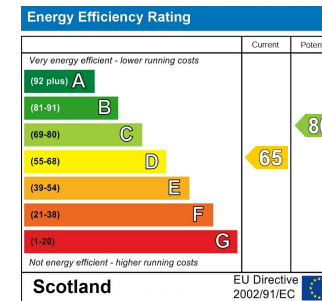

Agents Note: Whilst every care has been taken to prepare these particulars, they are for guidance purposes only. All measurements are approximate and are for general guidance purposes only and whilst every care has been taken to ensure their accuracy, they should not be relied upon and potential buyers are advised to recheck the measurements.

